

SMARTECH - CREATORS OF VERTICALLY MOVING DOORS, WINDOWS, AND WALLS. PREMIUM-BUILT SYSTEMS THAT ARE FULLY CUSTOMISED TO OPEN SPACES THAT FEEL JUST RIGHT FOR YOU!

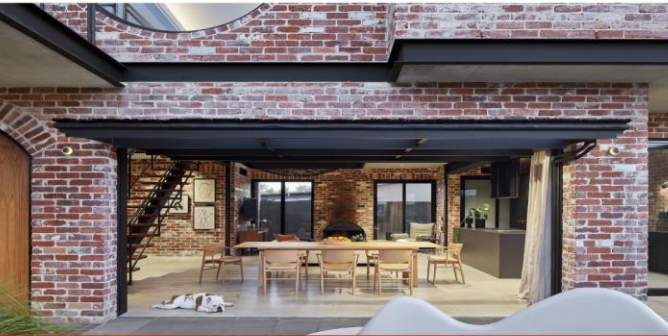

WELCOME TO SMARTECH

Smartech is a leading Australian specialist in the development of innovative and sustainable solutions for windows, doors, and wall systems, that open vertically. They develop tailor-made solutions for all market sectors – from residential to commercial and industrial projects.

Offering superior products and custom solutions, Smartech is recognised as one of the most respected and client-focused companies in the industry. Smartech have distinguished themselves as Australia's first choice amongst architects, developers, designers, and builders.

They continue to dedicate themselves to being a leading manufacturing company of major projects, that lead the way in both innovation and sustainability. All products are designed and manufactured in Australia.

Smartech offer high quality and technically superior products, excellent consulting service, technical know-how as well as an uncompromising focus on design, safety, and convenience.

WE PROVIDE A PROFESSIONAL 3-STEP PROCESS SERVICE AS FOLLOWS:

ADVICE SERVICE

1

Our highly trained staff will ensure that your design ideas become a reality. At this stage, we have a thorough discussion with you about your project and work with you to achieve a desired outcome.

2

DESIGN PHASE

During the design phase, we ensure that we listen to your vision, and we work with you to find the right solution.

3

DOCUMENTATION

Once the first two steps are complete, and the client has their offer, they review and if any queries prior to signing, our friendly staff will be available to answer.





1 ADVICE SERVICE

The following is an overview of the Advice Service that Smartech offer:

- We will meet with you and any other decision-makers to discuss and explore all possible options for your project.
- You can then either create your own shop drawings or choose our optional Design Consultation Service which includes this.
- Based on the shop drawings we will provide you with an estimate of the costs to ensure that your plans stay within your budget.
- We will also provide advice in relation to the installation process and likely timeframes for the manufacturing of your product. Thus, ensuring that you have an excellent understanding of how long the product will take to manufacture, and what the requirements will be on-site.

The first step is indeed an important one (and an exciting one!). Client satisfaction is of utmost importance to us, which is why we make sure we listen to your vision right from the start, thus ensuring that you end up with the right solution that best suits your project requirements.

2 DESIGN PHASE

Once we have completed Step 1, we then move on to the design phase of the process. This is where you truly begin to see your dreams come together.

If you are renovating or starting a new build, then we begin the process by completing a measured drawing of your door opening hence ensuring we have the correct dimensions for your project. We also check the final floor finishes and the lintel height. Our price component will be derived from these dimensions.

We will then create a shop drawing (at a cost) or show samples of the glazing break-up. We will also confirm our recommended installation (we provide technical data sheets, available in pdf and dwg files) or aluminium tracks, and the proposed frame finishes.

Once the design is completed, we will discuss any potential revisions to ensure that you are fully satisfied with your Smartech product. If applicable, any required alterations and design refinements are then made in the final detailed design. By taking this final extra step we are ensuring that your chosen design is 100% correct, hence eliminating any time delays due to mistakes.

3 DOCUMENTATION

After the design process is fully finalised, we then arrange to complete all the required documentation.

This step will consist of the client receiving a detailed quote and an offer for them to review. Once they are fully satisfied with this document, then they will sign it. If applicable, we may also provide a purchase order or a contract for the goods to the client as per all discussions held in Steps 1 and 2.

All necessary safety documents will be supplied to the client after the project is fully completed.

